







IP40     
 LED 50000 HOURS Ra 80+  
 CE   
 RoHS

# LED PANEL LIGHT

## User Manual

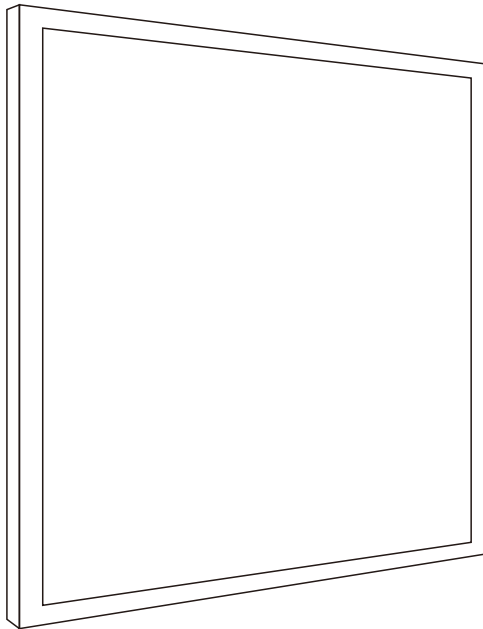

All the pictures are just for reference

### Item List

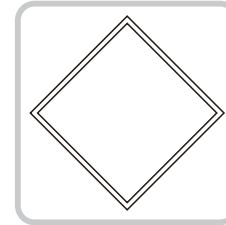

LED PANEL LIGHT

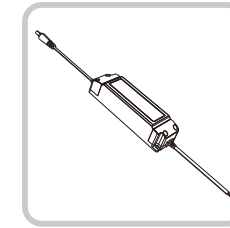

Driver

### Common Failures & Solutions

Common Failures	Solutions
Light is out	① Ensure the lamp is well connected.
	② Ensure the switch is turned on.
Flashing	① Ensure the Voltage is stable.
	② Ensure the dimmer is compatible.

### Size

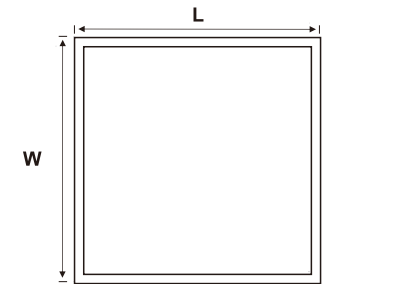

SIZE	L X W X H (mm)	L X W X H (Inch)
<b>European Size</b>		
<b>300X300</b>	295 X 295 X 9 mm	11.62 X 11.62 X 0.35"
<b>300X600</b>	295 X 595 X 9 mm	11.62 X 23.43 X 0.35"
<b>600X600</b>	595 X 595 X 9 mm	23.43 X 23.43 X 0.35"
<b>300X1200</b>	295 X 1195 X 9 mm	11.62 X 47.05 X 0.35"
<b>600X1200</b>	595 X 1195 X 9 mm	23.43 X 47.05 X 0.35"
<b>Germany Size</b>		
<b>620X620</b>	620 X 620 X 9 mm	24.41 X 24.41 X 0.35"

## Wiring

\*\*\*Cut off power before installation.

### European Size (Germany size) Panel connection diagram

#### Connection

\*\*\*reversing connection may cause lighting delay

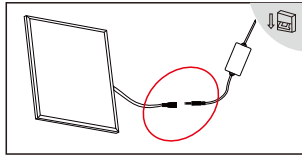

1. Connect driver to the panel

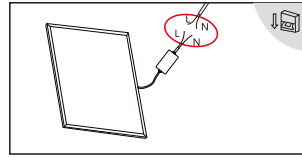

2. Then connect with city power ( L-L; N-N )

## Installation

\*\*\*Cut off power before installation.

### Recession

\*\*\*Customers can choose safety rope to avoid lamp falling caused by uncertain factors (earthquake, etc).

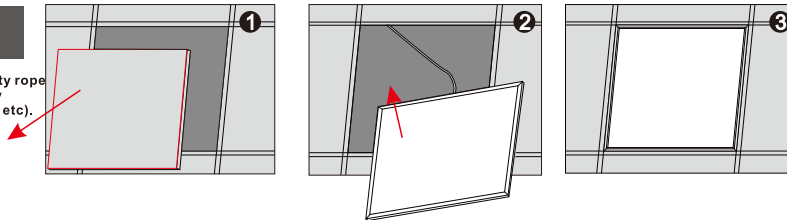

1. Remove the plasterboard from the ceiling. 2. Fix the panel into ceiling. 3. Installation finished.

### Suspension



Pendant Sets (4pcs / set)

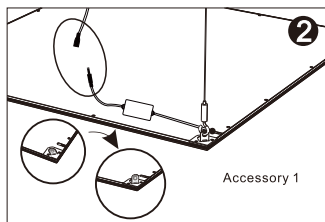
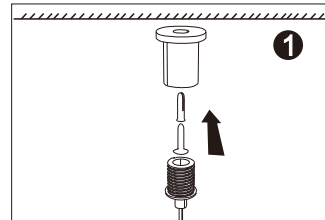

Accessory 1

or

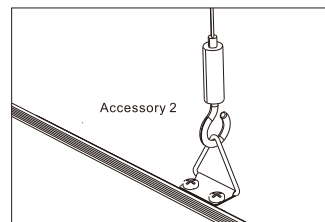

Accessory 2

Accessory 1 is for pendant type of 6060/6161/6262 LED panel.  
Accessory 2 is for pendant type of 3012/3013/6012/6013 LED panel.

## Surfaced mounted

### • Surfaced Mounted Frame JS-001

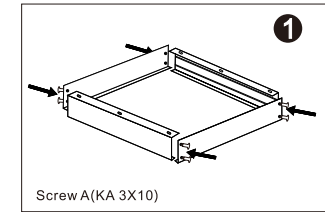
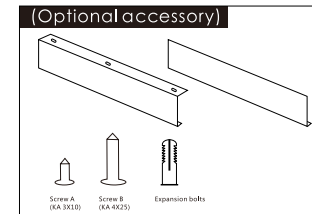

1. Assemble the four frames with Screw A to a whole square.

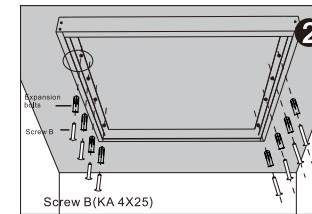

2. Fix the square frames to the ceiling with Screw B.

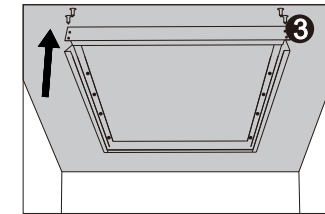

3. Demount one frame

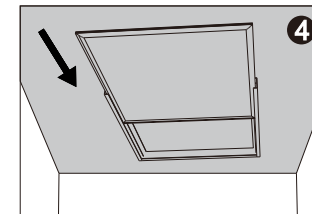

4. Put the panel into the frame square.

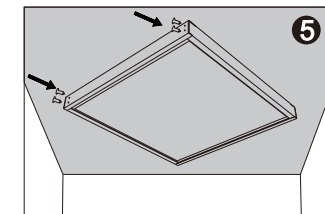

5. Fix the last frame with screw A.

## Notes

1. Indoor lighting only.
2. Before installation, ensure the LED panel is not damaged.
3. Don't stare at the LED luminous surface for long time.
4. Keep away from children, and ensure working electrical apparatus inaccessible to them.
5. No packages accessible to children, because they might be choked for playing, or eating the small accessories.
6. No covering, be away from fire or high-temperature substance.
7. Manufacturer reserves the right to offer no replacement or warranty to the led panels disassembled or repaired by users themselves.
8. Cut off power before cleaning the panels with dry cloth, use no chemical or corrosive substance .
9. Cut off power before installation.
10. The light source of this luminaire is not replaceable; when the light source reaches its endof life the whole luminaire shall be replaced.